

CASTER KIT - 05700-002-37-82

PREPARATION



1. Drain the machine completely.
2. Ensure incoming water to the machine is secured either by use of a shut-off valve or by disconnecting the incoming water line.
3. Disconnect electrical power at the breaker or disconnect switch.
4. Lock-out/tag-out in accordance with procedures and codes.

TOOLS REQUIRED

- 1/2" Wrench
- Wooden Block

PARTS INCLUDED

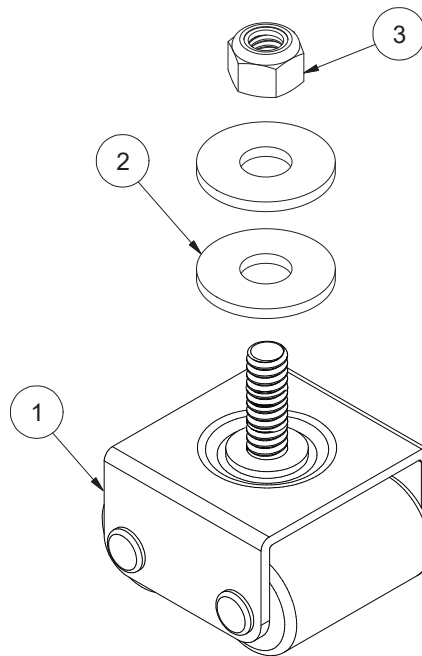

ITEM	QTY	DESCRIPTION	PART NUMBER
1	4	Caster, Roller	05340-002-37-83
2	8	Washer, Caster	05700-004-22-70
3	4	Locknut, 5/16-18 with Nylon Insert	05310-375-01-00

PROCEDURE



WARNING! Follow Preparation section on page 1 before proceeding!

1. Follow the Preparation section on page 1 and move the machine so all four feet can be accessed.
2. Remove front panel and set aside.

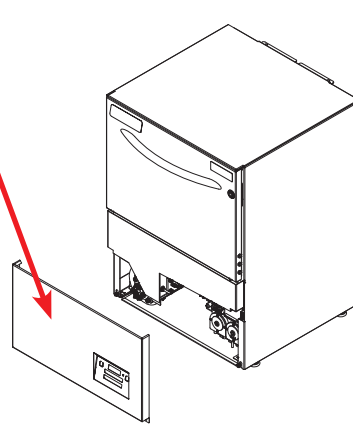

3. Elevate one side of the machine by inserting a wooden block under the frame.

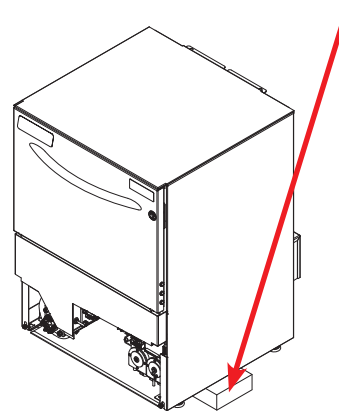

Wooden block is used in this step.

4. Remove first foot by unscrewing from frame by hand.

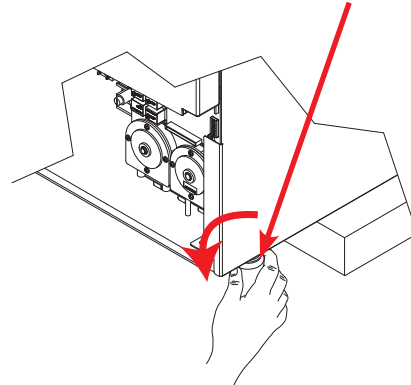

PROCEDURE

5. Place washer from kit onto caster from kit, and insert caster into square hole at corner of frame.

Washer and caster from kit are used in this step.

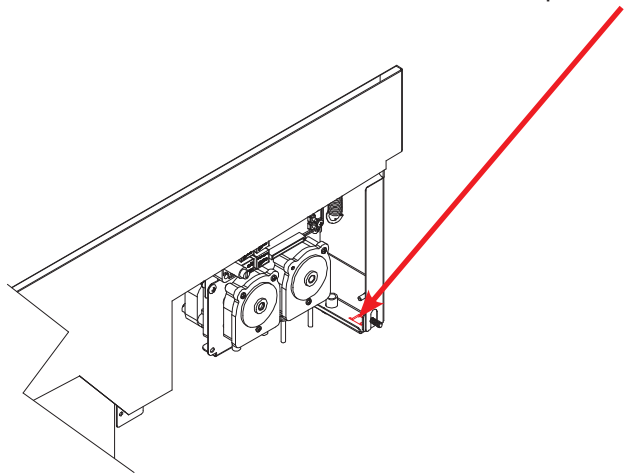

6. Place another washer from kit onto the caster, then secure the caster to the machine using a locknut from kit and 1/2" wrench.

Washer and locknut from kit are used in this step.

1/2" wrench used in this step.

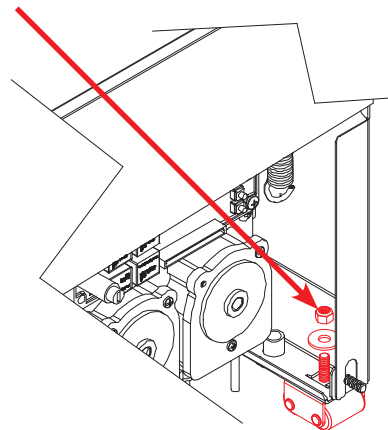

7. Repeat this process until all four adjustable feet have been replaced by casters.
8. Move the machine back into place and restore power and water.
9. The machine is now ready for operation.